

AFLS 10H HG

(USA/CAN UL type: AFLS10HHG)

The network compatible IP horn loudspeaker with the special added value



Fully
IP-based

Weather-
proof
IP66

Audio +
functionality

16kHz
eHD Voice

Assertive in every situation

The IP horn loudspeaker AFLS 10H HG is designed specifically to provide reliable voice signal transmission under rough indoor and outdoor conditions (e.g. at industrial areas and railway stations).

As it can be used as VoIP device or as SIP device (hybrid), the loudspeaker integrates easily into any Voice over IP system as well as any existing Commend Intercom system.

Thanks to the built-in microphone and the IVC feature (Intelligent Volume Control), it is possible to adjust the volume automatically to the ambient noise – even during playback.

Features and highlights

- Each loudspeaker can be addressed and configured individually
- End-to-end monitoring of connection and loudspeaker functionality
- High volume capacity and superior speech quality thanks to the integrated 10 watt class-D amplifier
- IVC (Intelligent Volume Control) automatically adjusts the volume setting to the ambient noise level
- Conversation and talk-back via the integrated microphone
- Audio monitoring enables ambient acoustic surveillance and automatic triggering of actions, such as voice announcements or emergency calls
- Built-in inputs and outputs, e.g. for monitoring and controlling third-party sub-sections or triggering predefined actions
- Power supply via PoE (Power over Ethernet) – only one Ethernet cable required
- No need for central amplifiers – ideal also for small-sized and remote PA zones
- Loudspeakers can be allocated to groups and zones without modifying the hardware or wiring
- Forward compatible (unlike classic PA systems), as new functions can easily be added via software download
- Combinable with virtual server landscapes via VirtuoSIS – provides all the benefits without the need for extra hardware

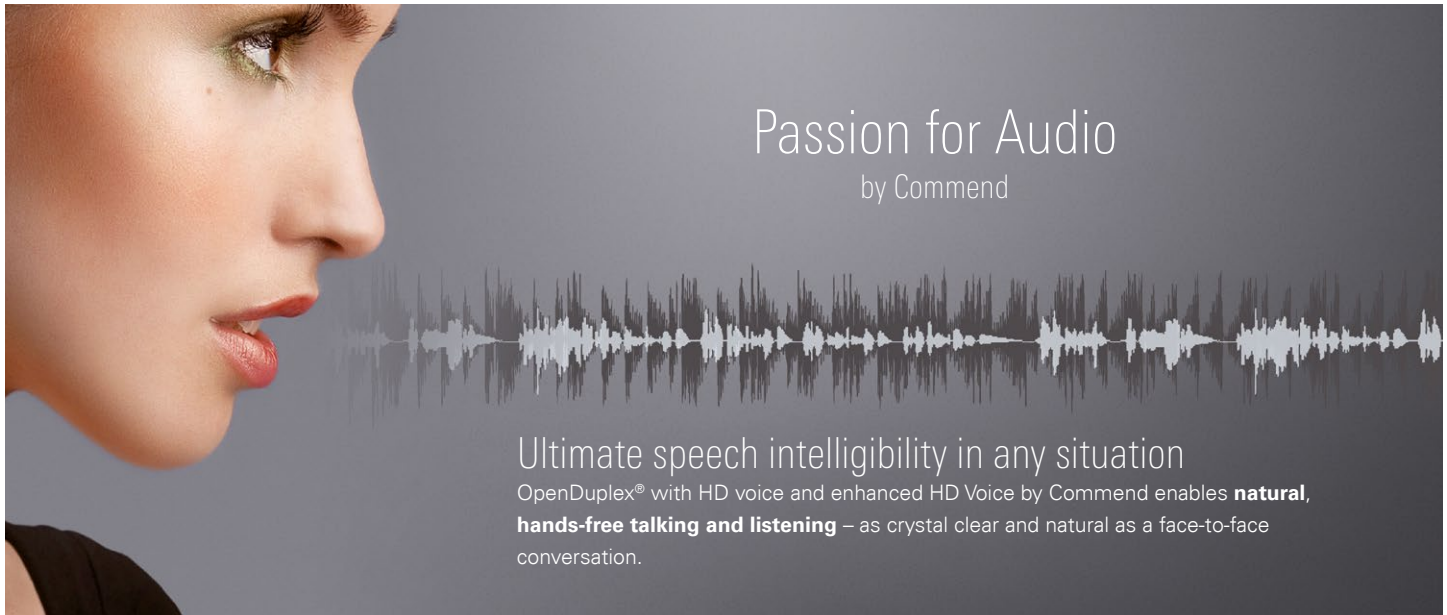





Passion for Audio

by Commend

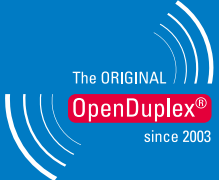
Ultimate speech intelligibility in any situation

OpenDuplex® with HD voice and enhanced HD Voice by Commend enables **natural, hands-free talking and listening** – as crystal clear and natural as a face-to-face conversation.

 <p>Natural communication</p>	<p>IVC</p> <p>Intelligent Volume Control</p>	 <p>High volume</p>	 <p>Background noise suppression</p>	 <p>Loudspeaker/microphone surveillance</p>
--	--	--	---	--

Audio // Basics

eHD Voice (IoIP)	Enhanced HD Voice by Commend transfers the audio signal at a bandwidth of 16 kHz , thus capturing the entire frequency spectrum of the human voice.
HD Voice (SIP)	HD Voice by Commend transfers the audio signal at a bandwidth of 7 kHz
STI	Speech Transmission Index 0.96 – measured under acoustic laboratory conditions (STI is a standard measure for speech intelligibility; it has a possible maximum value of 1.00, which corresponds to perfect intelligibility)
Amplifier	High efficient class-D amplifier with 10 W
Microphone	Omnidirectional electret condenser microphone for max. 7 m (23 ft) speaking distance
Loudspeaker	4 Ω loudspeaker with humidity-resistant special membrane type for optimum sound quality

Learn more

audio.commend.com

Audio // Functions

	IoIP	SIP
Dynamic background noise suppression virtually eliminates all ambient noise	<input type="checkbox"/>	<input type="checkbox"/>
Loudspeaker/microphone surveillance – ensures the availability of the Intercom station while reducing the need for manual verification of its functionality	<input type="checkbox"/>	<input type="checkbox"/>
Audio monitoring – fully automated emergency calls triggered by defined noise levels for more security	<input type="checkbox"/>	<input type="checkbox"/>
Peer-to-peer audio – reduces network and server load to ensure efficient use of resources	<input type="checkbox"/>	<input type="checkbox"/>
Audio recording and lip synchronous audio/video recording of conversations for documentation and evidence keeping purposes	<input type="checkbox"/>	<input type="checkbox"/>
Conference call function for simultaneous talking with multiple conversation partners	<input type="checkbox"/>	<input type="checkbox"/>
Speech activity detection senses when calls are finished (no microphone signal) and terminates the connection automatically	<input type="checkbox"/>	<input type="checkbox"/>
Simplex mode for applications requiring controlled communication – e.g. for security solutions based on the “push-to-talk/release-to-listen” method	<input type="checkbox"/>	<input type="checkbox"/>
OpenDuplex® for natural, hands-free communication	<input type="checkbox"/>	<input type="checkbox"/>
IVC (Intelligent Volume Control) automatically adjusts the device's volume setting to the ambient noise level	<input type="checkbox"/>	<input type="checkbox"/>
Public address functions	<input type="checkbox"/>	<input type="checkbox"/>

Example of use



Underground/overground railway stations and bus terminals

The millions of people who travel by railway or bus every day rely on being safe and well informed. In practice, however, this is not always the case: important announcements are often drowned out by the noise of arriving busses or trains. This is because common public address systems cannot be adapted to the ambient noise. If the ambient noise level increases suddenly, announcements become acoustically unintelligible.

The Commend audio function IVC (Intelligent Volume Control) adjusts the loudspeaker volume automatically to the ambient noise level during voice announcements and when playing back pre-recorded messages. The result is a superior level of intelligibility – even at extremely high ambient noise levels. But how does it work?

The technical process behind IVC

IVC automatically adjusts the volume level of the loudspeaker to the current ambient noise conditions if the sound pressure level exceeds 60 dB. The loudspeaker's basic volume level setting defines the required minimum level, which depends on the average local noise pollution level. In case of a sharp increase in ambient noise (as caused by a starting or moving car), IVC automatically increases the volume setting as needed by up to four levels. The highest possible adjustment results are achieved at ambient noise levels of around 85 dB.

Volume level change during an announcement

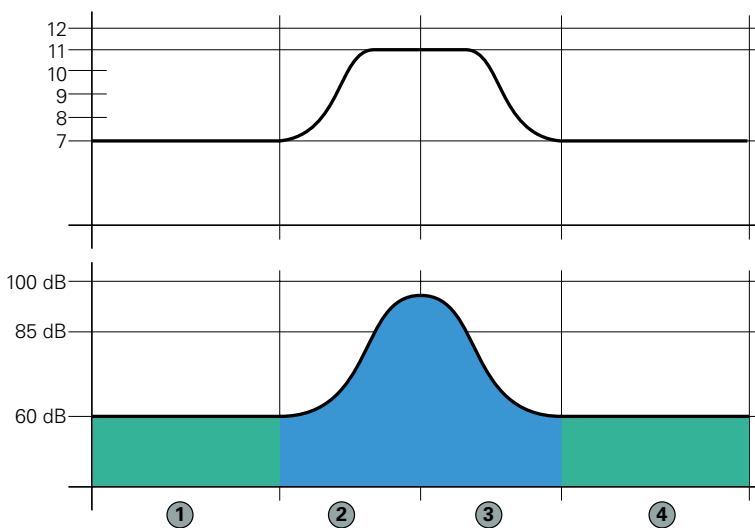

- ① Standard sound pressure level at approx. 60 dB: the announcement is made with the configured volume level (in this example level "7").
- ② A train enters the station, the sound pressure level rises above 60 dB: during the announcement, the volume level increases automatically (in this example by the maximum of four levels).
- ③ The train stops, the sound pressure level decreases back to 60 dB: during the announcement, the volume level is automatically reduced (in this example to the default level).
- ④ Standard sound pressure level again at approx. 60 dB: the announcement is made with the configured volume level (in this example level "7").

AFLS 10H HG

Technical specifications



Technical data

IP rating:	IP66 (acc. EN 60529)
Housing:	ABS plastic
Loudspeaker impedance:	4 Ω
Sound pressure level:	max. 118 dB
Loudspeaker frequency range:	350 Hz to 10 kHz (–10 dB)
IoIP transmission bandwidth:	16 kHz
SIP transmission bandwidth:	7 kHz
Loudspeaker transmission angle:	110° x 55° (H x V)
Microphone:	internal microphone: electret condenser microphone built-in microphone: MIC 480 polar patterns: omnidirectional
Amplifier:	integrated class-D amplifier with 10 W
Inputs:	2 inputs for floating contacts (IoIP: detection of 5 input states)
Outputs:	relay output (switch-over contact) ¹⁾ max. 60 W (DC)/37.5 VA (AC), max. 2 A, max. 60 V DC/30 V AC expected life: min. 5 x 10 ⁴ (2 A), 10 ⁵ (1 A)
Connections:	pluggable screw terminals IP uplink: shielded RJ45 modular jack
Power supply ²⁾:	PoE (Power over Ethernet): IEEE 802.3af standard power consumption: Class 0 (0.44 W to 12.96 W)
Cabling:	min. Cat. 5
Protocols (IoIP):	IPv4, UDP, DHCP, RTP, RTCP, SNMPv2c, SNTPv4
Protocols (SIP):	IPv6, IPv4, TCP, UDP, HTTP (RFC 2617, RFC 3310), RTP (RFC 3550), RTCP, DHCP, SDP (RFC 2327), SIP (RFC 3261), SNMPv2, STUN, TFTP, URI (RFC 2396), DTMF Decoding (RFC 2876, RFC 2833), SIP User Agent (UDP RFC 3261)
Audio codecs (SIP):	G.711 a-Law, G.711 μ-Law, G.722
Data rate:	10/100 MBit/s (Full/Half Duplex) Auto MDIX
Operating temperature range:	–20 °C to +70 °C (–4 °F to +158 °F)
Storage temperature range:	–20 °C to +70 °C (–4 °F to +158 °F)
Relative humidity:	up to 90%, non-condensing
Colour:	light grey (RAL 7035)
Dimensions (W x H x D):	180 x 120 x 235 mm (7.09 x 4.72 x 9.25 in)
Weight incl. package:	approx. 1,800 g (3.79 lbs)

Line length in LAN

The maximum line length of Cat. 5 cabling in a LAN is 100 m (328 ft) – e.g. from switch to Intercom station.

Extent of supply

- IP horn loudspeaker
- Short reference

System requirements

IoIP

Intercom Server

- GE 800 (min. PRO 800 5.0, min. base licence PRO 1) with G8-IP or
- GE 300 (min. PRO 800 5.0, min. base licence PRO 1) with G3-IP or
- IS 300/G8-IP-32 (min. PRO 800 5.0, min. base licence PRO 1) or
- VirtuoSIS (min. PRO 800 5.0, min. base licence PRO 3)

Configuration software

- min. CCT 800 5.0 build 1017
- IP Station Config (included in setup of CCT 800 5.0)

SIP

- Compatible SIP server (see “Compatibility SIP PBX” on page TE | 2) or
- VirtuoSIS (min. PRO 800 5.0, min. base licence PRO 3) or
- GE 800 with G8-VOIPSERV or
- Serverless

¹⁾ The relay output may only be connected to an ES1 or a SELV circuit! An ES1 circuit as per IEC/EN/UL 62368-1 or a SELV circuit as per IEC/EN 60950-1 must be separated safely from a dangerous electrical circuit (e.g. 230 V or 110 V mains power), e.g. by means of double insulation. The ES1 or SELV circuit must not exceed 60 VDC or 42.4 VAC_{peak} (30 VAC_{eff})!!

²⁾ Use PoE network switch or PoE injector only. PoE acc. IEEE 802.3af; output voltage 36–57 VDC; min. 12.95 W (per Ethernet port); LPS/PS2 or Class 2 output (IEC/EN/UL 62368-1).

Network requirements for use as SIP device

Ports

- The configuration via the web interface is done via TCP port "80" (cannot be configured).
- The communication from the SIP device to the SIP server is done via the following ports (both are configurable):
 - SIP: UDP port "5060"
 - RTP: UDP port "16384" (incoming)

Network requirements for use as IOLP device

IP addresses and ports

- For the AFLS 10H HG, the DHCP functionality is available. If DHCP is not used, the AFLS 10H HG must have a fixed IP address.
- In case of a changing public IP address, a dynamic registration of an AFLS 10H HG is possible.
- The communication from the software IP Station Config is done via port "16399" (cannot be configured).
- The communication from the AFLS 10H HG to the Intercom Server (UDP protocol) is done via port "16400" (configurable).

QoS requirements

- Maximum one-way delay 100 ms
- Delay-Jitter not above 50 ms
- 0% packet loss for perfect audio quality

Bandwidth

For further information on bandwidth, see guideline "IOLP Technology".

Compatibility SIP PBX

Basically, a SIP device can be operated with any SIP server. The following server types have been tested explicitly by Commend and therefore a proper functionality can be confirmed:

Manufacturer ¹⁾	Type	Version
Cisco	Cisco Call Manager Cisco Unified Communication Manager	Versions 5, 6, 7, 8, 9
Digium	Asterisk	Versions 1.2, 1.4, 1.6
Avaya (former: Nortel)	CS1000	Version 6
Avaya	Avaya Aura™ (Avaya Communication Manager, Avaya Session Manager)	Release 6.1
Innovaphone	Virtual Appliance IPVA	Version 9 final
Alcatel	OmniPCX Enterprise (OXE)	Release 9
Siemens	Hipath 4000 Hipath 3000 + HG 1500	Version 5
3CX	3CX for Windows	3CX PhoneSystem Versions 9, 10, 11
Starface	Starface free	Versions 4.x, 5.x
Aastra (former: Ericsson)	MX-ONE	Version 4.1 SP 1
Kamailio	Kamailio (OpenSER)	Version 3.3.0
FreeSWITCH	FreeSWITCH	Version 1.1 Beta1
ELMEG	elmeg ICT880	Version 7.67D
2N®	2N® Netstar IP	Version 3.1.0.96
AVM	Fritz!Box Fon 7170 Fritz!Box Fon 7270	Version 29.04.87 Version 54.05.05
Sipgate	sipgate.at, sipgate.de	tested in Dec 2010
Vodafone Arcor	vodafone.de	tested in Jan 2011
blue SIP	blueSIP.net	tested in May 2011
Mitel	3300ICP	12.0.0.49

¹⁾The listed products and company names are brand names or registered trademarks of their respective owners.

AFLS 10H HG

Installation instructions

Mounting instructions

- The direction of the cable glands of the installed loudspeaker must face downwards to ensure the functionality of the built-in microphone.
- Use only certified/specified cable glands and blanking plugs in extent of supply in order to fulfil the IP rating (2xM20).
- To change the position of the loudspeaker, adjust the bracket as required (by loosening/tightening the screws).
- This device is intended to be mounted, handled and used by skilled persons only.
- Use 3 screws with a diameter from 5 to 5.5 mm. Fastening, screw type and screw length depends on the mounting ground.
- Install or store this device out of the reach of children and do not allow persons unfamiliar with the device and these instructions to handle and operate the device.

Dimensions

Measuring units in mm (in), not to scale!

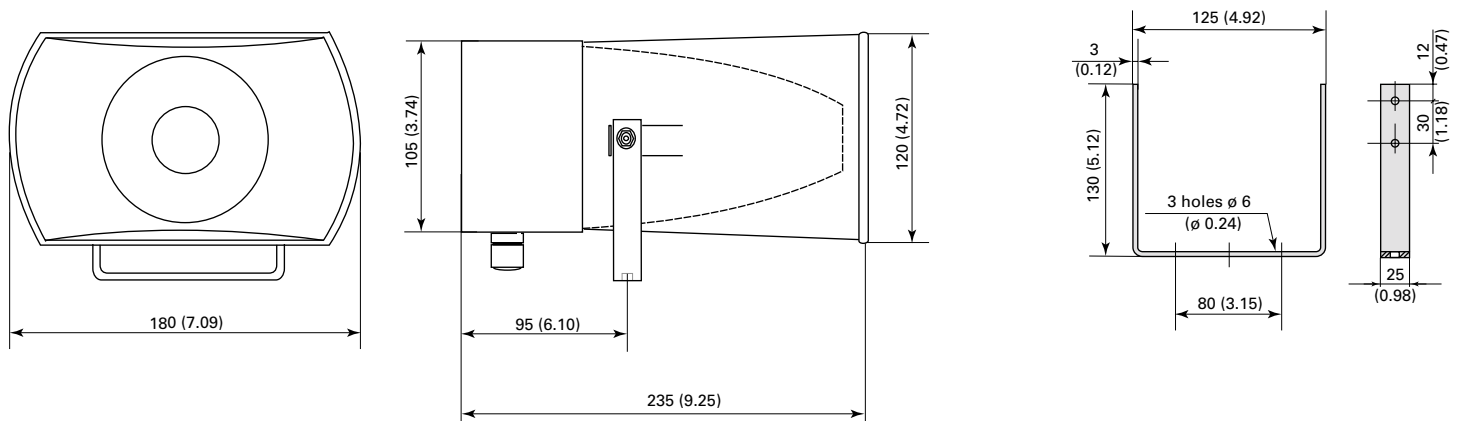

Connection (rear view)

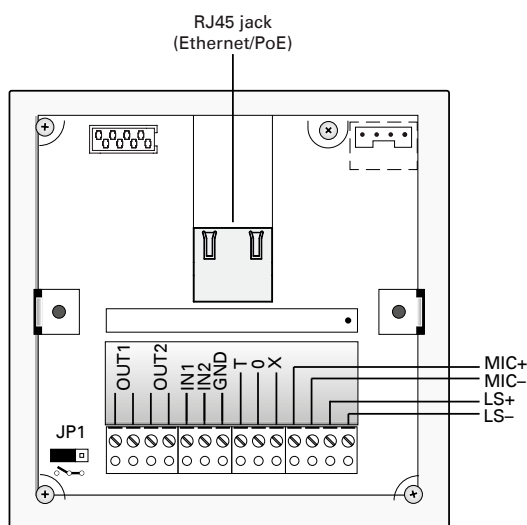

Attention

Due to limited space inside the housing (distance between RJ45 jack and housing is 40 mm), only RJ45 crimp connectors with up to 30 mm total length shall be used.

Notes

- **OUT 1** is factory adjusted as normally open contact. Via the jumper JP1, the output can be converted into a normally closed contact.
- **OUT 2** is factory adjusted as normally open contact.
- PoE required (see "Technical data" on page TE | 1)

AFLS 10H HG

Complementary information

Configuration via IP Station Config

Follow the steps below to operate the AFLS 10H HG either as SIP or VoIP device:

- Click on **Query stations** to indicate all subscribers within the network.
- In the column **BootMode**, select the operation mode of the AFLS 10H HG. The following options are available:
 - **Boot as SIP**: The AFLS 10H HG operates as SIP device.
 - **Boot as VoIP**: The AFLS 10H HG operates as VoIP device.

Configuration via CCT 800

General configuration

Before setting up the AFLS 10H HG, follow the steps below:

- Receive the current configuration.
- Go to: **Subscriber > Station properties > IP-Terminals**
- Carry out the IP configuration for the AFLS 10H HG.

Microphone configuration

To ensure a high speech quality, the equalisation preset for the built-in microphone MIC 480 has to be selected. For this, follow the steps below:

- Go to: **Subscriber > DSP-Features > tab Microphone, Tones**
- In the drop-down list **Mode MIC - frequency response**, select the option "MIC480".

Volume Configuration

If the call mode OpenDuplex® is configured, it is recommended to set the volume level to maximum "7". For this, follow the steps below:

- Go to: **Subscriber > Audio - Features > tab Duplex, Simplex, Full Duplex**
- In the drop-down list **Full Duplex limit**, select the option "7".

To enable the best call comfort, it is recommended to activate the IVC function ("Intelligent Volume Control"). For this, follow the steps below:

- Go to: **Subscriber > DSP-Features > tab voice control**
- Make sure the checkbox **IVC** is activated.

Note

For further information on configuring via CCT 800, see manual "Intercom Server Configuration".

Configuration in via web interface

In operation mode as SIP device, the internal microphone of the AFLS 10H HG is set per default. Follow the steps below to activate the external microphone:

- Open page **Audio** in the web interface.
- In the section **In**, activate the radio button **External Microphone (EM)**.
- Click on **Apply**.

Quality tested. Reliable. Smart.

COMMEND products are developed and manufactured by Commend International in Salzburg, Austria.

The development and manufacturing processes are certified in accordance with **EN ISO 9001:2015**.



The technical data contained herein has been provided solely for informational purposes and is not legally binding. Subject to change, technical or otherwise. VoIP®, OpenDuplex® and Commend® are trademarks registered by Commend International GmbH. All other brands or product names are trademarks or registered trademarks of the respective owner and have not been specifically earmarked.

A strong worldwide network

COMMEND is represented all over the world by local Commend Partners and helps to improve security and communication with tailored Intercom solutions.

www.commend.com