

ET 862



2-Wire DSP Intercom Module ET 862

The digital 2-wire Intercom module ET 862 has been developed for installation in existing housings or for construction of special Intercoms. The modern DSP-technology is securely fitted in a rugged housing with mounting tabs for easy installation.

Applications for the Intercom module ET 862 are all kinds of call- / emergency call stations, where the station is built-in and only the external call button is used. This means special solutions for e.g. emergency call pillars, elevator cabins,

ticketing machines or barriers at entrances and exits can be created, that optimally satisfy function and optical appearance of the customer specifications.

The Intercom modules ET 862 are manufactured in the new DSP-technology, which enables functions such as Audio-Monitoring or Loudspeaker-/Microphone-Surveillance. The modules are prepared for future download of new functions (updates to new versions) and can utilize the OpenDuplex® capability of the GE 200 and GE 700 Intercom Servers.

ET 862

Digital 2-wire Intercom module in rugged build-in housing with new DSP-technology. Integrated digital duplex controller for optimal speech quality at the door, even from a distance or with high ambient noise levels. Output contact for direct connection of a door opener.



Technical Data – Benefits

TECHNICAL DATA

Keyboard:	Possibility of connecting 12 buttons, with plug for row/column matrix
Microphone:	Omnidirectional electret microphone for max. 7 m (23 ft) speaking distance
Loudspeaker:	Special membrane type for optimal sound quality, sound pressure: 85 dB/1 W/1 m (3.28 ft), 50 Ohm
Amplifier:	built-in amplifier 1.5 W output power with built-in loudspeaker: 0.5 W
Input:	1 input for floating contacts, max. 1 kOhm
Output:	1 relay output 30 V / 1 A
Call indication:	red LED
Frequency range:	200 – 7,000 Hz
Operating temperature range:	-20° C to +70° C (-4° F to 158° F)
Storage temperature range:	-20° C to +70° C (-4° F to 158° F)
Relative humidity:	up to 95 %
Plug:	pluggable screw terminals
Cabling:	star feed, 2-wire, twisted
Power supply:	from central Option: external power supply for greater line length (12–24 VAC or 15–35 VDC, 500 mA)
Signalling:	2B + D (2 x 64 kBit/s speech, 16 kBit/s data)
Measurements:	87.5 x 109 x 40 mm (3.45 x 4.29 x 1.58 in)
Weight incl. package:	195 g (0.4 lbs)

SYSTEM REQUIREMENTS

GE 200 (min. Pro 05.0) with G2-GED-4 (all software versions)
 GE 700 (min. Pro 05.0) with G7-GED-4 (min. software V02.2)

BENEFITS

- Excellent speech quality, even from a distance (up to 7 m / 23 ft)
- Cabling with 2 wires, star feed, fully digital transmission of speech and data
- DSP-technology, prepared for software download of future functions
- Audio-Monitoring, adjustable integration time and noise level
- Loudspeaker-/Microphone Surveillance
- Integrated amplifier with 0.5 W output
- Built-in loudspeaker and microphone
- Output contact for direct connection of e.g. doors or gates
- Connection of 12 buttons with row/column matrix

LINE LENGTH

Cable type: AWG:	0.5 mm 24	0.6 mm 22	0.8 mm 20
F-YAY (installation cable PVC) 100 nF/km (30.5 nF/1,000 ft)	*	2,000 m 6,562 ft	2,000 m 6,562 ft
J-02YS(St)Y: Cat. 5 cable, foamed polyethylene, 45 nF/km (13.7 nF/1,000ft)	1,500 m 4,922 ft	2,000 m 6,562 ft	3,000 m 9,843 ft
J-02YS(St)Y (above) with external supply	3,000 m 9,843 ft	3,000 m 9,843 ft	3,000 m 9,843 ft

*...no data, because this diameter is not available for this cable type.

EXTENT OF SUPPLY

- 1 Intercom module including:
- Light pipe and plexiglass LED cover, optionally as light guide for the conversation-LED.
 - Short reference



Installation

PRECAUTIONS

- When opening the stations ESD precautions must be observed.
- The stations may be installed by authorised service engineers only.

MOUNTING INSTRUCTIONS

- Do not expose the station to extreme temperature (below -20°C or above $+70^{\circ}\text{C}$ / -4°F to 158°F).
- Please take care that the front panel of the ET 862 is attached to the mounting plate without margin. Otherwise an "acoustic short circuit" occurs, which can considerably influence the sound quality of the ET 862.

KEYPAD MATRIX

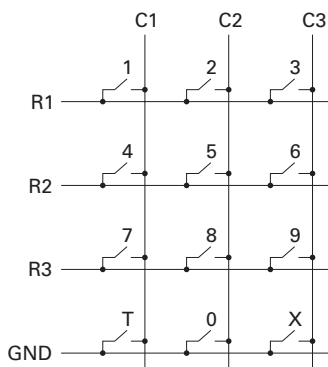

Line length between keypad and ET 862: max. 50 cm (19.7 in)

LIGHT GUIDE FOR CONVERSATION-LED

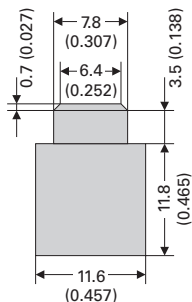

Plexiglass LED Cover

The plexiglass LED cover only fits LED 2 (see Measurements). For call indication either LED 1 or LED 2 can be used. LED 1 is in the same position as the LED of the 4-wire Intercom module ET 562.

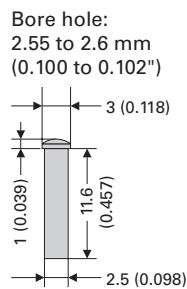

Light Pipe

CONNECTION

Optional: terminals PWR: external, floating power supply for greater line length (12 – 24 VAC or 15 – 35 VDC, 500 mA).

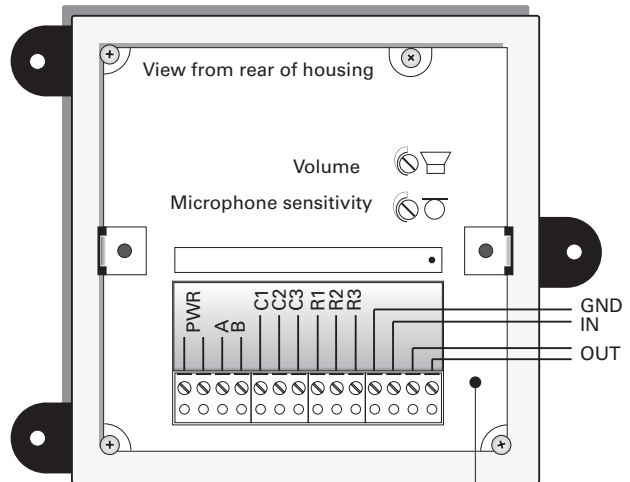

Note: OUT factory adjusted as "make" contact. With the jumper JP1 (inside of housing) it can be converted into a "open" contact.

MEASUREMENTS

Measurements in mm (inch), not scale!

